

# 200 x 100 x 40 cm\*

## 78.7" x 39.4" x 15.8"

### KIT AUTOCLICK RUEDAS PLUS 3-400



**5** Años Garantía  
Years Guarantee  
Jahre Garantie  
Ans Garantie  
Anos de Garantia

**SIMONRACK**

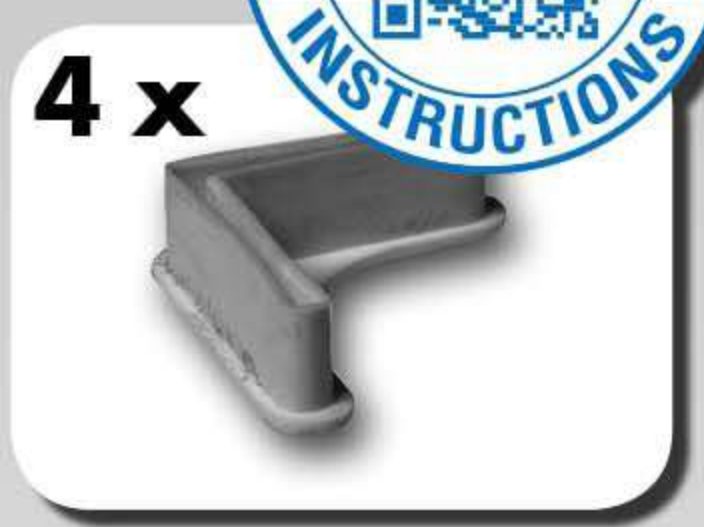
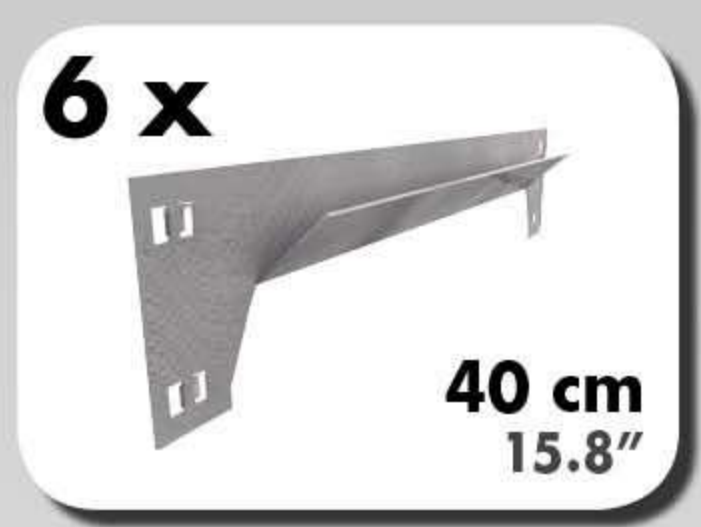
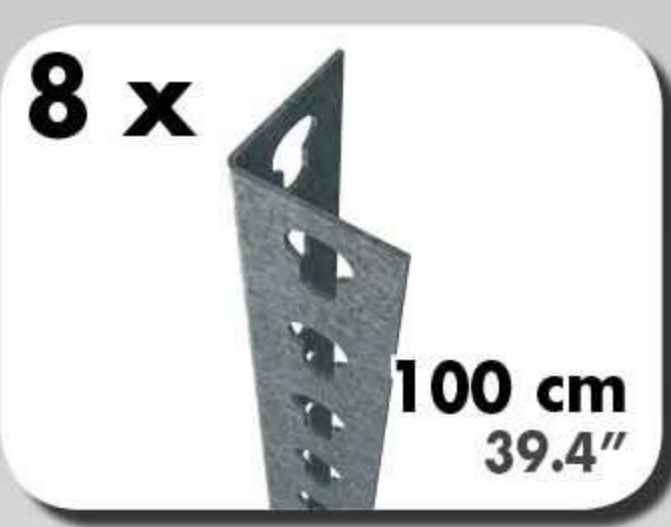

\*MEDIDAS EN USO USED MEASUREMENTS  
MASSNAHMEN IM EINSATZ MESURES EN EMPLOI MEDIDAS EM USO:  
2050 x 1010 x 410 mm ( 80.7" x 39.7" x 16.1")



ESTANTERIAS SIMON S.L. B.50.556.463  
PG. ALFAMEN C/ POLIGONO C, N°3  
ALFAMEN (ZARAGOZA)

**Simon**  
**Rack**

SINCE 1964 - MANUFACTURER



www.simonrack.com



INSTRUCTIONS

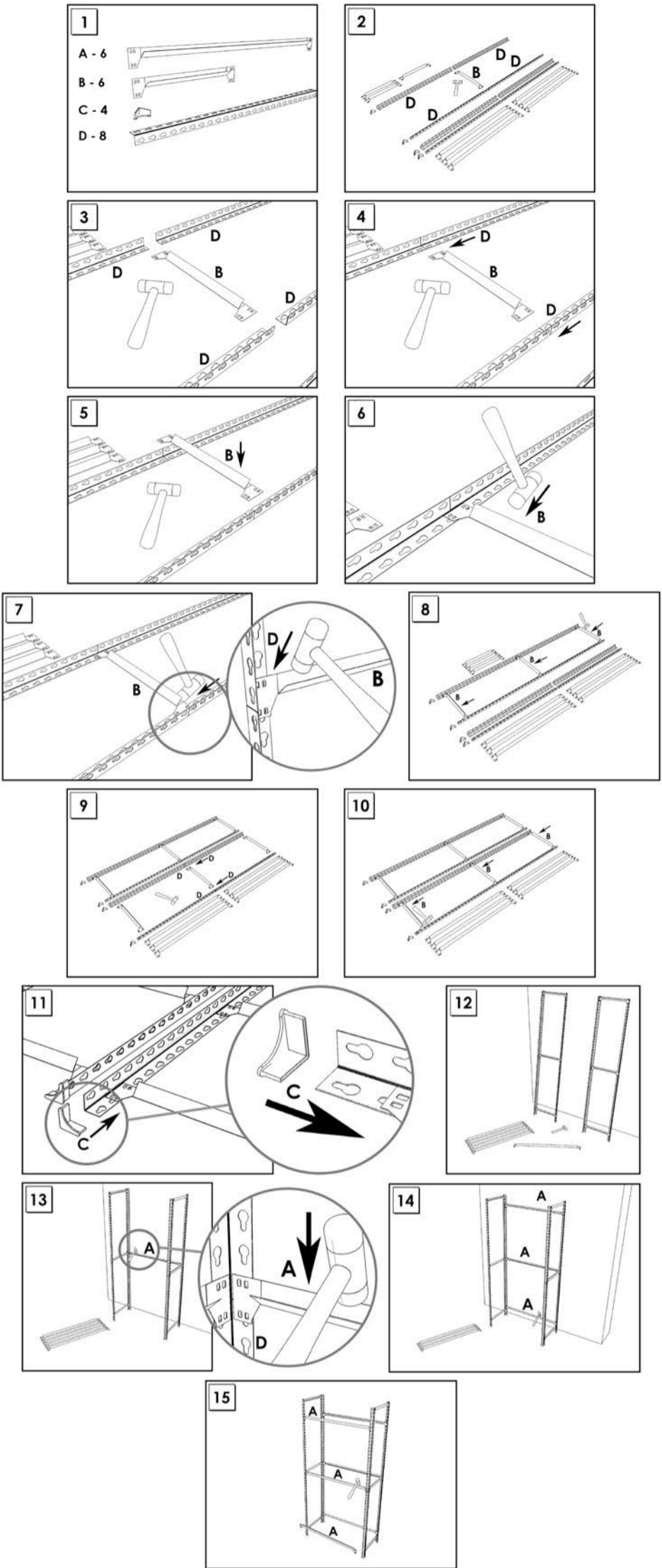

On-line instructions: [www.instructionsrack.com/autoclick](http://www.instructionsrack.com/autoclick)

[www.simonrack.com](http://www.simonrack.com) • [www.simonrack.com](http://www.simonrack.com) • [www.simonrack.com](http://www.simonrack.com) • [www.simonrack.com](http://www.simonrack.com)

**SIMONCLASSIC**



Up to: **150 Kg**  
(331 lb)  
Kg./Shelf  
Uniformly Distributed Load



**SIMONCLICK**



Up to: **400 Kg**  
(882 lb)  
Kg./Shelf  
Uniformly Distributed Load



**SIMONOFFICE**



Up to: **275 Kg**  
(606 lb)  
Kg./Shelf  
Uniformly Distributed Load



**SIMONTALLER**



Up to: **700 Kg**  
(1543 lb)  
Kg./Shelf  
Uniformly Distributed Load



**BANCOS DE TRABAJO**



Up to: **800 Kg**  
(1764 lb)  
Kg./Shelf  
Uniformly Distributed Load



**ALTILLOS Y PASILLOS ELEVADOS**



**SIMONHOME**

Up to: **150 Kg**  
(331 lb)  
Kg./Shelf  
Uniformly Distributed Load



**TAQUILLAS**



**SIMONINOX**



Up to: **900 Kg**  
(1984 lb)  
Kg./Shelf  
Uniformly Distributed Load



**SIMONTITÁN**



Up to: **900 Kg**  
(1984 lb)  
Kg./Shelf  
Uniformly Distributed Load



**SIMONPALET**

Up to: **4500 Kg**  
(9921 lb)  
Kg./Shelf  
Uniformly Distributed Load



**SIMONLEVER**

